

QUICKLOCK - PORTABLE SYSTEM

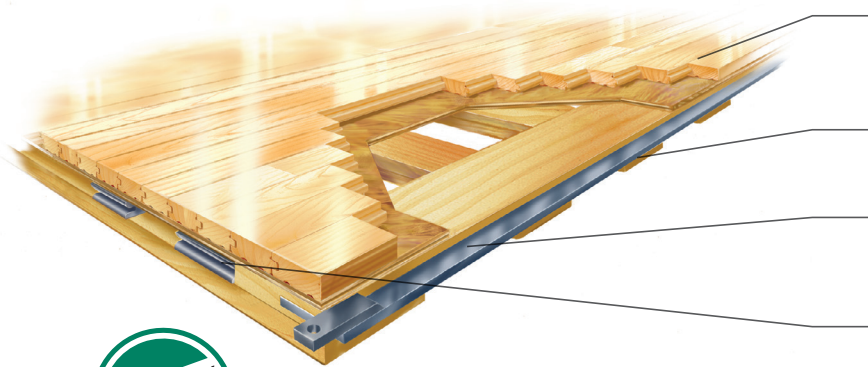

FLOORING

North American Maple
Thickness 20mm / Width 57mm

RESILIENCE

13mm Powershok pads

SUBFLOOR CONSTRUCTION

Full sleeper and panel subfloor framing
with laminated double sleepers

LOCKING SYSTEM

Panels of 1.23m x 2.14m – Weight: 80kgs



Recycled Contribution:
ReziilSleeper Subfloor System
includes components with
recycled content

ONE MATERIAL, THREE NATURAL GRADES

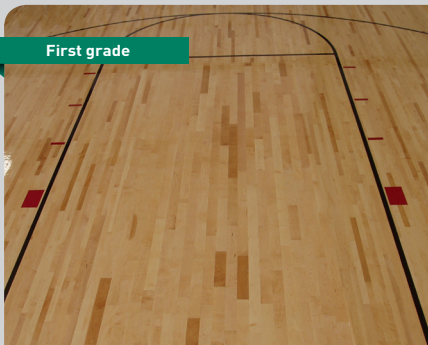

PARTNER OF MAJOR SPORTS EVENTS



QUICKLOCK SYSTEM PORTABLE SYSTEM



ASSEMBLY ATTACHMENT

QUICKLOCK™

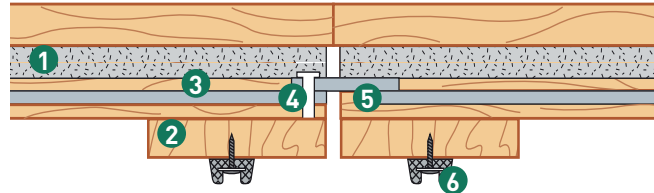

- 1 Subfloor (11 mm)
- 2 Laminated (19 mm x 89 mm) Sleeper
- 3 Full Subfloor Frame
- 4 Quick Pin
- 5 Continuous Steel Tongue
- 6 Resilient pads (optional)

PRODUCT CHARACTERISTICS

STANDARD	REQUIREMENT	UNIT	RESULTS	
PRODUCT DESCRIPTION				
Finish Flooring	-	-	Hardwood Maple Strip Flooring	
Sub-Floor	-	-	129.9 x 214 cm	
-	-	-	Quicklock steel plate interlocks with high impact polyethylene grooves and heavy duty Steel tongue + full sleeper and panel subfloor framing with laminated double sleepers (19 x 89 mm)	
Thickness	EN 428	-	mm	83
Weight	EN 430	-	kg/m ²	32
SPORT PROPERTIES				
Shock absorption	EN 14808	≥ 25	%	51.7
Vertical deformation	EN 14809	≤ 5	mm	1.8
Sliding coefficient	EN 13036-4	80 to 110	-	83
Ball bounce	EN 12235	≥ 90	%	97.3
TECHNICAL CHARACTERISTICS				
Abrasion resistance	EV ISO 5470-1	≤ 0.08	g	0.07
Impact resistance	EN 1517	≥ 8	-	No damage
Indentation resistance	EN 1516	≤ 0.5	-	No damage
Resistance to rolling load, 1500 N	EN 1569	-	-	✓
CLASSIFICATION				
Fire	EN 13501-1	-	-	
DECLARATION OF PERFORMANCE				
-	-	-	-	Fire Shock Absorption Sliding Coefficient Abrasion Resistance Resistance to rolling load Resistance to fire Resistance to wear